



ENQUIRY FORM BIG SPACE CAR FRAME KIT

ORDER:

CLIENT:

MARK:

DATE: 24/01/14

DATA:	Load	Q =	<input style="width: 60px; height: 15px;" type="text"/>	kg	
	Car+door	P2 =	<input style="width: 60px; height: 15px;" type="text"/>	kg	
	Travel	Lc =	<input style="width: 60px; height: 15px;" type="text"/>	mm	
	Pit Depth	PD=	<input style="width: 60px; height: 15px;" type="text"/>	mm	min. 150mm
	Headroom	H=	<input style="width: 60px; height: 15px;" type="text"/>	mm	min. 2500mm
	Shaft width	SW=	<input style="width: 60px; height: 15px;" type="text"/>	mm	
	Shaft depth	SD=	<input style="width: 60px; height: 15px;" type="text"/>	mm	
	Speed	V=	<input style="width: 60px; height: 15px;" type="text"/>	m/s	max.0,5m/s

CABIN:	Cabin width internal	CWI=	<input style="width: 60px; height: 15px;" type="text"/>	mm	
	Cabin depth internal	CDI=	<input style="width: 60px; height: 15px;" type="text"/>	mm	
	Cabin height internal	CHI=	<input style="width: 60px; height: 15px;" type="text"/>	mm	
	Thickness cabin wall		<input style="width: 60px; height: 15px;" type="text"/>	mm	
	Thickness of floor		<input style="width: 60px; height: 15px;" type="text"/>	mm	max.60mm
	Thickness of cabin roof		<input style="width: 60px; height: 15px;" type="text"/>	mm	

OTHER:	Distance shaft wall inside cabin	C1=	<input style="width: 60px; height: 15px;" type="text"/>	mm	max. 360mm
	Distance shaft wall c/c guide	F=	<input style="width: 60px; height: 15px;" type="text"/>	mm	max. 240mm
	Distance c/c guide to inside cabin		<input style="width: 60px; height: 15px; background-color: yellow;" type="text" value="0"/>	mm	std. 115mm when wall 25mm T90/B or T125/B
	Type of Guide		<input style="width: 60px; height: 15px;" type="text"/>	mm	
	Distance between guide brackets		<input style="width: 60px; height: 15px;" type="text"/>	mm	80bis, 90bis, 1008SL
	Type of Piston		<input style="width: 60px; height: 15px;" type="text"/>	mm	
	Closed jack Length	CL=	<input style="width: 60px; height: 15px;" type="text"/>	mm	
	Total Piston stroke	Lp=	<input style="width: 60px; height: 15px;" type="text"/>	mm	
	Piston in 2 pieces <input type="checkbox"/>		<input style="width: 60px; height: 15px;" type="text"/>	mm	
	Length flex. Tube		<input style="width: 60px; height: 15px;" type="text"/>	1/h	
	Travels per hour		<input style="width: 60px; height: 15px;" type="text"/>	No.	
	Moveble toeguard		<input style="width: 60px; height: 15px;" type="text"/>		

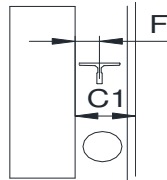

- POWER UNIT:**
- MRL MC
 - MRL MC with oil collector
 - Valve 3010/S 3010/S-DLV A3 NGV-A3
 - Motor Voltage 400/690V 230/400V 415/720V
 - GMV Soft starter
 - Oil heater 500W
 - Electrical emergency lowering NGV 12V 24V
 - Programming tool NGV
 - Oillevel indicator
 - Noise reduce material in power unit
 - Pre arranged for oil cooler
 - Oil cooler 6000Kcal/h 14000Kcal/h
 - Min. pressure switch 3010
 - Mobil Hydraulic oil Des 46
 - Mobil Syndraulic (Eco)

Fax: +46 472-456 99
eMail: info@gmv.se