

DFG	A	B	C	D	E
600	832	615	800	474	424
800	1032	815	1000	674	624

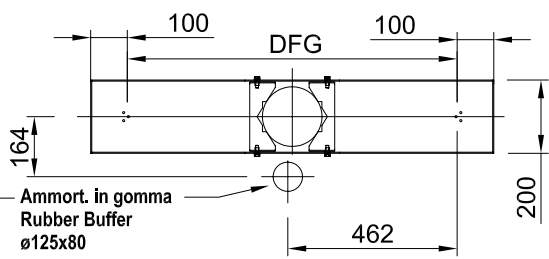
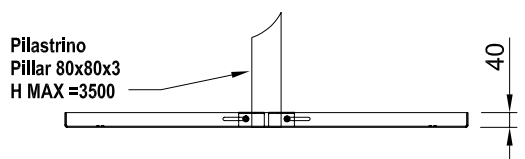
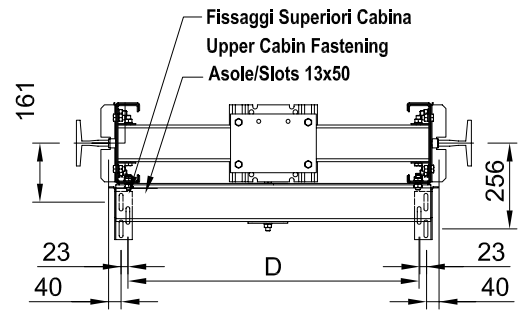

CARATTERISTICHE TECNICHE TECHNICAL DATA			
CARICHI LOADS	Peso Cabina Max. / Car Weight (Pc)		545 Kg
	Massa Arcata / Car Frame Weight (Pa)		145 Kg
	Portata Nominale / Useful load (Q)		480 Kg
	Pc + Pa + Q Max		1170 Kg
Tipo Guide STD	T125/82/16 - T125/68/9 - T90/75/16		
Guide Type STD	T89/62/16 - T82/68/9		
ALTRI TIPI A RICHIESTA / OTHER TYPES ON REQUEST			
Pattino tipo / Guide shoe type	a striscio		
Ruote a richiesta / Bearings Rollers optional	ø 80		
Diametro Max. Pistone "Dp" / Max Ram Diameter "Dp"	ø 195		
Fossa Tecnica Min (fondo sp.80mm)	462 mm		
Min Technical Pit (car floor th. 80mm)	462 mm		
Fossa a normativa a EN 81.2 (fondo sp.80mm)	1100 mm		
Pit EN 81.2 (car floor th.80mm)	1100 mm		

ARCATA TIPO - CAR FRAME TYPE

4805 1:1

PAGINA	PAGE	1
DATA	DATE	11/03/08
Nr. DOC.	DOC. Nr.	T6AOL001
EDIZIONE	EDITION	2.0



LAVIS - TRENTO

La TECHNO LIFT si riserva di apportare senza preavviso qualsiasi tipo di modifica. TechnoLift reserves the right to introduce any kind of changes without prior notice.